

## How to Fit & Operate your Wand Controlled Vertical Blind

### You should have:

First check you've got all the fittings that come with your blind.

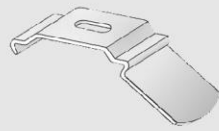

Top fix brackets: x 2 min



Face fix bracket: x2 min

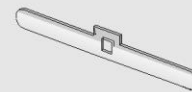

Louvre hanger: x 1 per louvre



Alan Key



Wood screws: x 4



Stabilising chains: x 2



Rawplugs: x 4



Wand: x 1



Weight: x1

Standard fixings for the most common installations supplied

### Getting started

#### YOU WILL NEED:

- A drill with correct bit
- A crossheaded screwdriver
- A metal tape measure
- A pencil

- Your brackets are packed with your headrail. Please ensure you've located them before disposing of the packaging.
- There are two bracket types. One that can be used to top fix the blind into a recess and another to face fix into a frame or a wall.
- Please read the following instructions carefully before you start fitting your blind.

### To Fit the Brackets

1. Position the brackets at a suitable distance away from any window handles or. If top fixing, use a louvre hanger as a guide to positioning your holes. If face fixing, mark where the screws will go using the holes in the bracket as a guide.
2. Ideally, position the brackets 5cm in from each end of the head rail. Any additional brackets should be spaced evenly.
3. For a wall or lintel, use a drill with a suitable sized bit to make your holes, and push in rawplugs. You may need different screws from those provided i.e. 1½" 8's
4. For a wooden frame, screw your brackets into position with the screws provided. A pilot hole may be needed to allow easier fixing of the screws.
5. Fix the bracket into place and repeat on the other side of the blind.

### Fit the Wand

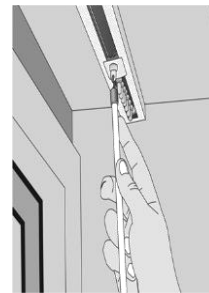

1. To fit the wand, hook onto the eyelet found within the headrail.
2. Using the wand, turn the hooks inside the headrail that hold the louvres to the open position.

### To fit the head rail

1. **Face fix** - loosen the screws on the front of the brackets, hook the head rail into position and tighten the bracket screws to secure.

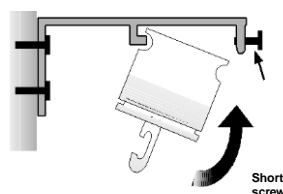

2. **Top fix** - with the thumb tab on the bracket facing back, hook the front edge of the head rail into the bracket and push up at the back until it clicks into position.

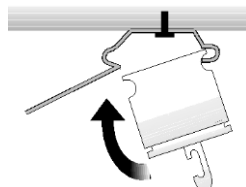

## Operating your blind:

Operating your blind is easy. Just follow these instructions.

- To adjust the angle of the louvres, twist the wand and the louvres will turn through 180 degrees.
- To open and close the blind, pull the wand ensuring the louvres are in the open position.
- From time to time your louvres may be knocked out of alignment. To re-align the louvres remove them from the headrail and draw into the open position. Using the wand rotate the hooks (that hold the louvres onto the headrail) until they are aligned. You will feel some resistance and you may hear a clicking noise, this is normal and you should continue to operate the wand until the hooks are fully aligned.

## To Fit the Louvres

1. Keeping them in a roll, slot a hanger into each one making sure that all the hangers are the same way up. This should be done with the protruding lugs facing up.

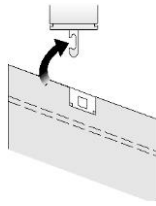

2. Clip the louvres onto the headrail. To shorten the length of the louvres, turn the hangers upside down in the louvres.

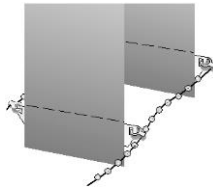

3. Starting from one end, snap the stabilising chain on to the bottom weights on both sides.