

BREAKAWAY CORD CONDENSER

Breakaway cord condenser is pre-fitted to the lift cords so that when a horizontal force is applied to the cords entering the condenser it safely breaks away eliminating any hazardous loops.

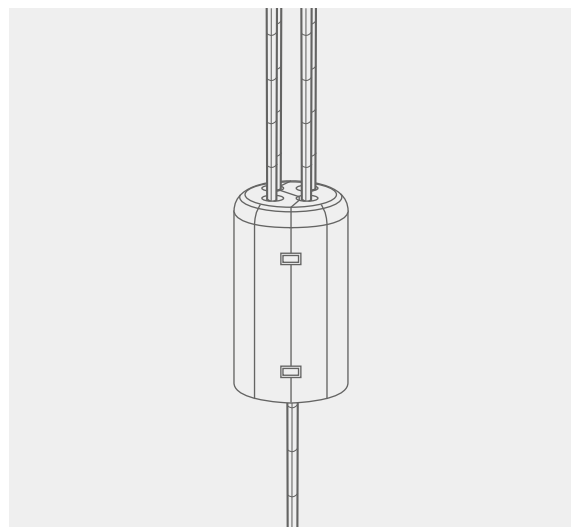
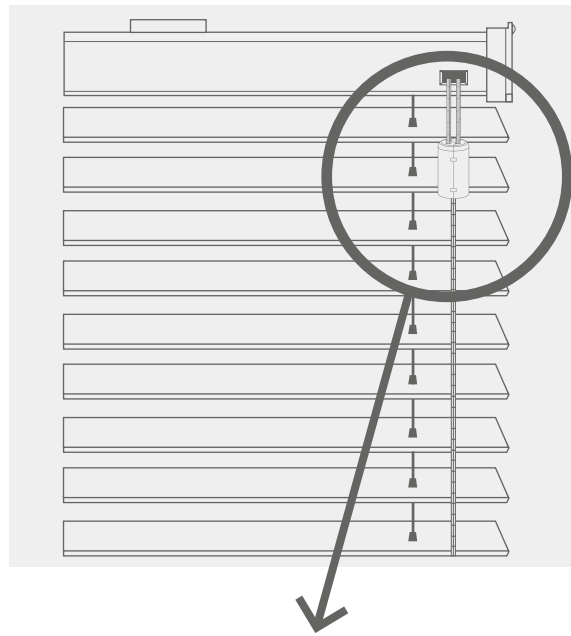

If the cord condenser is pulled apart:

Untangle and untwist cords.

For 2 cords: Press the cord condenser together until it is fully closed.

For 3 cords: Place the loose cord in the opening in one half of the cord condenser and press the cord condenser together until it is fully closed.

If there are any doubts that the cord condenser has not been re-attached correctly it can be tested by placing your arm between the cords and pressing downwards. The condenser should break apart with minimal force, if it does not breakaway tie cords out of reach of children and contact a reputable blind company to repair the blind.

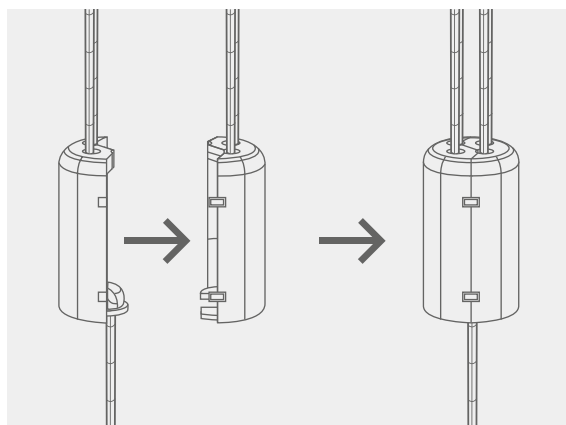
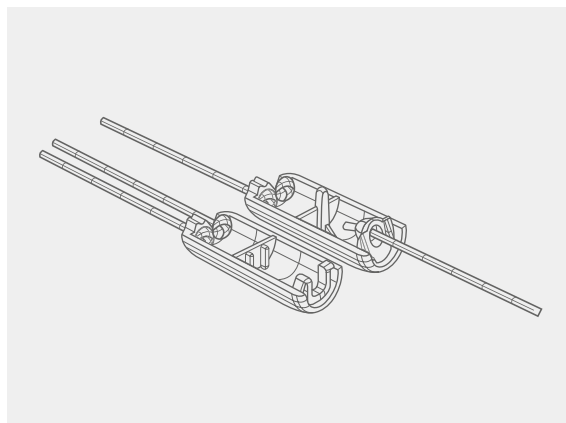

FITTING INSTRUCTIONS: WOOD VENETIAN BLINDS

Concept Blinds Direct

OPERATION INSTRUCTIONS

To tilt blind: Pull on required tilt cord tassel to tilt slats to the open/closed position.

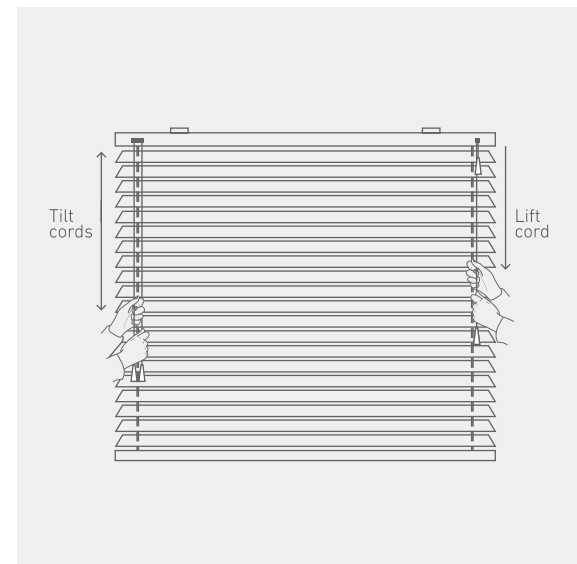

Tilt blind horizontal before raising/lowering to extend the life of the blind.

To lower blind: Move lift cord towards middle of the blind pulling down gently until cord lock releases.

To raise blind: Pull lift cord downward until blind reaches desired height.

To lock cords: Pull lift cord towards the outside of the blind and release. Cord will lock automatically.

MAINTENANCE

The product is maintenance free however we recommend that regular visual checks are completed to ensure that no components have been damaged, which could result in operating difficulties and/or cause a safety risk.

If any maintenance is required we recommend that the work is carried out immediately, by a reputable blind company.



WARNING

Young children can be strangled by loops in pull cords, chains, tapes and inner cords that operate the product.

To avoid strangulation and entanglement, keep cords out of the reach of young children. Cords may become wrapped around a child's neck. Move beds, cots and furniture away from window covering cords.

Do not tie cords together. Make sure cords do not twist and create a loop.

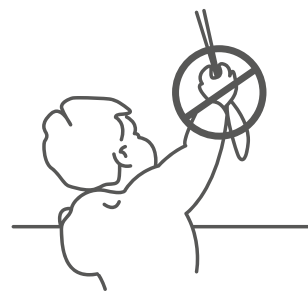

Wood Venetian Blinds

YOU SHOULD HAVE

WOOD VENETIAN
ITEM LIST

Brackets

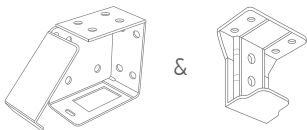

Safety device



Wood screw for bracket -
(2 per bracket)
2 screws per valance clip/
return clip,
2 screws for safety cleat.
4 screws for hold down bracket

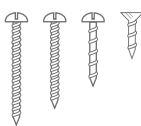

Valance clip & return clip

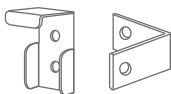

Hold down brackets



TOOLS REQUIRED

Screw driver Drill



Tape measure Pencil

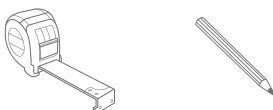

STEP 1

The installation of this
product should be
conducted by someone
competent in DIY.

OUTSIDE RECESS

If the blind is to be fitted
outside the window ensure that
measurement C is the same.
Follow instructions for FACE
FIXING. To calculate C=(A-B)/2.

INSIDE RECESS

TOP FIX to the lintel or FACE FIX
brackets to the window frame.

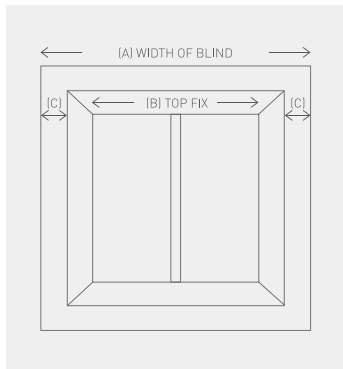

STEP 2

The installation height
of this blind must not
be less than 1500mm
from the floor.

TOP FIXING

Measure and mark the distance
between the wall and the
back of the bracket, allowing
for obstructions like handles
that protrude into the recess
area. The brackets should be
positioned 6mm wider than
the blind at each end. Hold
each bracket into place and
mark the hole positions. Fit
each bracket using the screws
provided. Please ensure
fixings are suitable for the
wall/surface to which you are
mounting the brackets.

FACE FIXING

The brackets should be
positioned 6mm wider than
the blind at each end. Hold each
bracket into place and mark
the hole positions. Fit each
bracket using the screws
provided. Please ensure
fixings are suitable for the
wall/surface to which you are
mounting the brackets.

SIDE FIXING

Hold each bracket into place
and mark the hole positions.
Fit each bracket using the
screws provided. Please ensure
fixings are suitable for the
wall/surface to which you are
mounting the brackets.

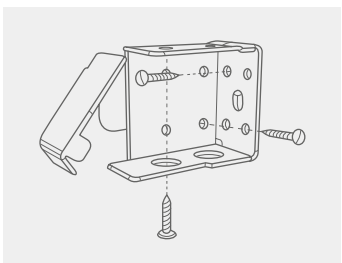

STEP 3

SUPPORT
BRACKET

For larger width blinds a support
bracket is required. Align the top of
the support bracket with the top of the
mounting bracket before installation.
Install with the bigger flap of the
support bracket on the top equally
spaced along the width and clear of
the slat ladder positions.

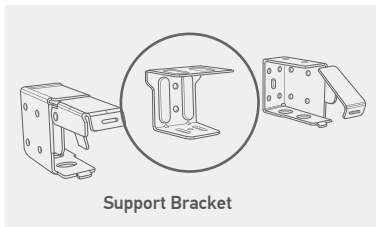

Open the gate of the box brackets and
slide the headrail into position then
snap the brackets closed.



Number of ladders	End fix brackets	Support brackets (supplied)
2	2	0
3	2	1
4	2	2
5	2	3

HOLD DOWN BRACKET
(OPTIONAL)

Hold down brackets: Using two small
screws, screw hold down bracket to
window facing or wall. Snap bracket pin
ends into the hole at bottom rail end.

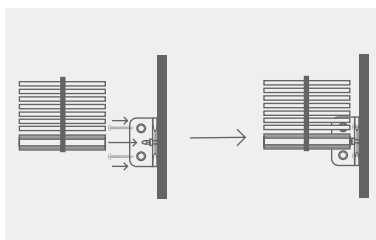

STEP 4

ATTACHING THE VALANCE

DUAL LOCK

Remove the plastic from the dual
lock positioned on the headrail.
Place the valance in the required
position and firmly press the
valance against the dual lock for 5
seconds to secure the valance.

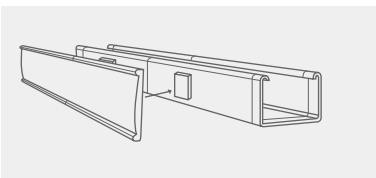

VALANCE CLIP (OPTIONAL)

Screw valance clips onto the
back and level with the top of the
valance using the screws provided.

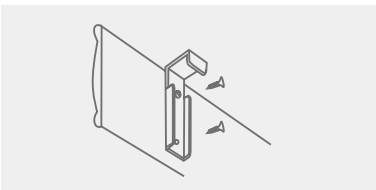

Hook valance clip with valance
attached onto the top of the headrail.

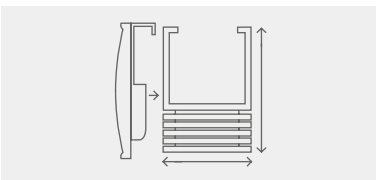

VALANCE RETURNS
(OPTIONAL)

If your blind has been supplied with
valance returns screw one end of the
valance return clip onto the valance
using screws provided. Align the edge
of the valance return with the valance.
Screw the other end of the valance clip
onto the valance return.

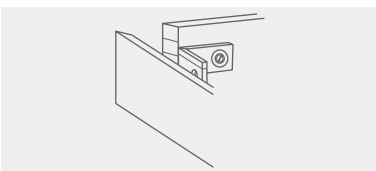

STEP 5

SAFETY DEVICE

Cord safety cleat - The safety
cleat shall be installed as close to
the headrail as possible and in all
cases not less than 1500mm from
the floor.

The Cord must be fully
accumulated around the safety
cleat(s) when the blind is not in use.

Use the table below to determine
the distance required between the
cleats to fully accumulate the cords
when the blind is fully raised.

Drop of Blind	*Distance between cord cleats (centre to centre)
1-1000mm	100mm
1001-2000mm	150mm
2001-3000mm	300mm

Place the safety cleat in the desired
position on the wall and mark the
positions of the holes with a pencil.

(Note: Based on cord up to 2.8mm,
17m can be accumulated in total.)

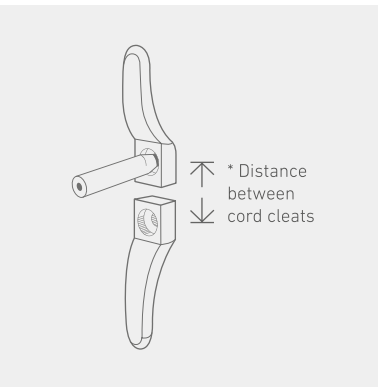

Mark the hole positions and drill
as required.

Use the screws provided to
attach the safety cleat to the wall.

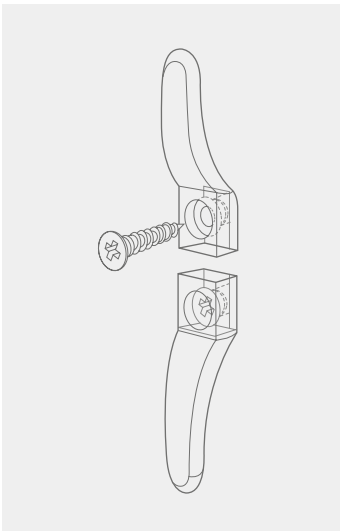

Wrap the cords around the
cord cleats in a figure of 8.

When the cords are fully
accumulated ensure they
are secure so when any
cord is pulled no excess cord
is released.

